

DS-2CE5582P(N)-VFIR3 600 TVL Vari-focal IR Dome Camera

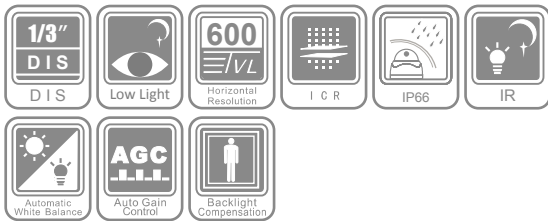

Key features

- 1/3" DIS
- True Day/Night
- 600 TVL Horizontal Resolution
- 2.8 - 12 mm /F1.4 Vari-focal Lens
- 40m IR Distance
- Wide Operating Temperature Range

Dimensions

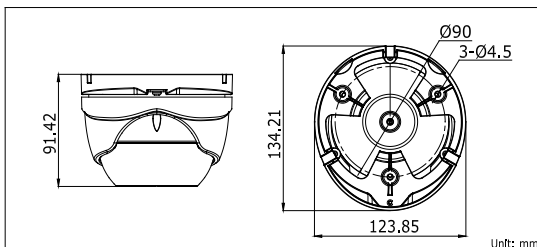

Specifications

DS-2CE5582P(N)-VFIR3	
Camera	
Image Sensor	1/3" DIS
Signal System	PAL/NTSC
Effective Pixels	720(H)×480(V)
Min. Illumination	0.1Lux @ (F1.2,AGC ON),0 Lux with IR 0.14Lux @ (F1.4,AGC ON),0 Lux with IR
Shutter speed	PAL: 1/25 s to 1/15,000 s NTSC: 1/30 s to 1/15,000 s
Lens	2.8-12mm @ F1.4 Angle of view: 92° - 27.2°
Lens Mount	φ14
Angle Adjustment	Pan: 0 - 360°, Tilt: 0 - 90°, Rotation: 0 - 360°
Day & Night	IR cut filter with auto switch
Horizontal Resolution	600 TVL
Synchronization	Internal synchronization
Video Output	1Vp-p composite output (75 Ω/BNC)
S/N Ratio	More than 52 dB
BLC	On
General	
Working Temperature/Humidity	-40 °C - 60 °C (-40 °F - 140 °F) Humidity 90% or less (non-condensing)
Power Supply	12 V DC ± 10%
Power Consumption	Max. 4 W(Max. 6.5 W with IR cut filter on)
Ingress Protection level	IP66
IR Range	Approx. 30 to 40 meters
Dimensions	134.21 × 123.85 × 91.42mm(5.28" × 4.88" × 3.60")
Weight	800g (1.76l lbs)

Available models

DS-2CE5582P-VFIR3, DS-2CE5582N-VFIR3