

DS-2CC11A5/11A7/11A8P(N)-A(-C)

700 TVL High Definition Box Camera

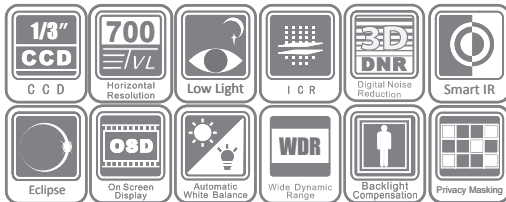

Key features

- 1/3" SONY CCD
- Super Low Illumination
- 700 TVL Horizontal Resolution
- 3D Digital Noise Reduction, Smart IR
- 75 dB Wide Dynamic Range (DS-2CC11A7P(N)-A)
- Highlight Compensation (DS-2CC11A8P(N)-A)
- True Day/Night
- OSD Menu

Dimensions

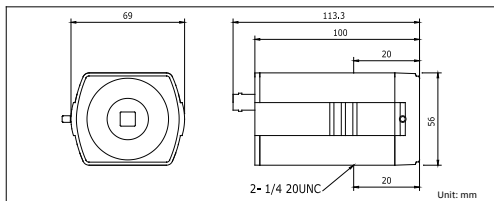

Accessories



DS-1212ZJ
(Indoor wall mount)



DS-1213ZJ
(Indoor / Outdoor Wall Mount)



DS-1311 / 2 / 3HZ
(Indoor / Outdoor camera housing)



DS-1320HZ
(Indoor camera housing)

	DS-2CC11A5P(N)-A(-C)	DS-2CC11A7P(N)-A(-C)	DS-2CC11A8P(N)-A(-C)
Camera			
Image Sensor	1/3" SONY CCD		
Signal System	PAL/NTSC		
Effective Pixels	PAL: 976 (H) × 582 (V), NTSC: 976 (H) × 494 (V)		
Min. Illumination	Color: 0.001 Lux @ (F1.2, AGC ON), 0.0001 Lux @ (F1.2, AGC ON, sensitivity × 512) B/W: 0.0001 Lux @ (F1.2, AGC ON), 0.00001 Lux @ (F1.2, AGC ON, sensitivity × 512)		
Shutter speed	PAL: 1/50 s to 1/100,000 s, NTSC: 1/60 s to 1/100,000 s		
Lens Mount	C/CS mount		
Auto Iris	DC/Video drive		
Day & Night	IR cut filter with auto switch		
Wide Dynamic Range	Digital	75 dB	Digital
Horizontal Resolution	700 TVL		
Synchronization	Internal/Power synchronization		
Video Output	1Vp-p composite output (75 Ω/BNC)		
S/N Ratio	More than 62 dB		
Menu			
Camera ID	On/Off (16 letters, position adjustable)		
Auto Gain	Low/Middle/High/Off		
D/N Mode	Auto1/Auto2/Day/Night		
White Balance	Auto trace WB1/Auto trace WB2/Manual/Auto Control		
Privacy Masking	On/Off, maximum 12 zones		
Motion Detection	Mode 1/Mode 2/Off		
BLC	Area/Value/Off		
HLC	-	-	Compensation Intensity/Off
WDR	-	Value/ Contrast /WD exposure compensation/Return	-
RS-485	Address/Protocol/Baud Rate		
Anti-Flicker	On/Off		
Language	English/Chinese		
Function	SMART IR, Digital Wide Dynamic Range, Eclipse, Digital Noise Reduction, Sharpness, Brightness, Saturation, Resolution, Electronic image stabilization, Digital Zoom, Mirror, Defect Pixel Correction, auto-iris correction	SMART IR, Eclipse, Digital Noise Reduction, Sharpness, Brightness, Saturation, Resolution, Electronic image stabilization, Digital Zoom, Mirror, Defect Pixel Correction, auto-iris correction	Digital Wide Dynamic Range, Eclipse, Digital Noise Reduction, Sharpness, Brightness, Saturation, Resolution, Electronic image stabilization, Digital Zoom, Mirror, Defect Pixel Correction, auto-iris correction
Scene	Indoor Standard , Indoor Backlight , Outdoor, Low illumination, IR Standard, Customize	Indoor Standard , Indoor Backlight , Outdoor, Low illumination, Customize	Indoor Backlight , Outdoor Backlight
General			
Working Temperature/ Humidity	-10 °C - 60 °C (14 °F - 140 °F) Humidity 90% or less (non-condensing)		
Power Supply	24 V AC ± 10%, 12 V DC ± 10% (-C series support 100 - 240 V AC)		
Power Consumption	Max. 5 W (Max. 10 W with IR cut filter on)		
Dimensions	69 x 56 x 113.3 mm (2.72" × 2.20" × 4.46")		
Weight	400 g (0.88 lbs)		

Available models

PAL: DS-2CC11A5P-A, DS-2CC11A5P-C, DS-2CC11A7P-A, DS-2CC11A7P-C, DS-2CC11A8P-A, DS-2CC11A8P-C
NTSC: DS-2CC11A5N-A, DS-2CC11A5N-C, DS-2CC11A7N-A, DS-2CC11A7N-C, DS-2CC11A8N-A, DS-2CC11A8N-C